

## **Branson area family vacation: 5 nights, Spring Break, March 15-20, 2026, \$ 675**

5 nights at a **2-bedroom cabin at Blue Green's Wilderness Club at Big Cedar Resort** on Table Rock Lake, 5 miles south of Branson, Missouri. Sleeps up to 6.

Square ft. - 1,275; Kitchen - 1 Full; Bedding includes 1 King bed, 1 Queen bed, 1 Sofa bed most comfortable for 2 children; Bath(s) - 2 Full; Laundry is In Unit; Additional info - Tub w/ jets, Wood Fireplace. Family-friendly resort with, pools, trails, exercise room, internet (part of a \$10/night fee), more.

**Only \$ 675 (\$135/night)** for the 2 Bedroom described here –Advance payment is required.

Check-in: Sunday afternoon, March 15, 2026;      Check-out: Friday morning, March 20, 2026

Contact: David or Cathy Barfield; Cathy's cell: 913-235-4959; David email: [dave.barfield@gmail.com](mailto:dave.barfield@gmail.com)

### **BLUEGREEN WILDERNESS CLUB™ AT BIG CEDAR®**

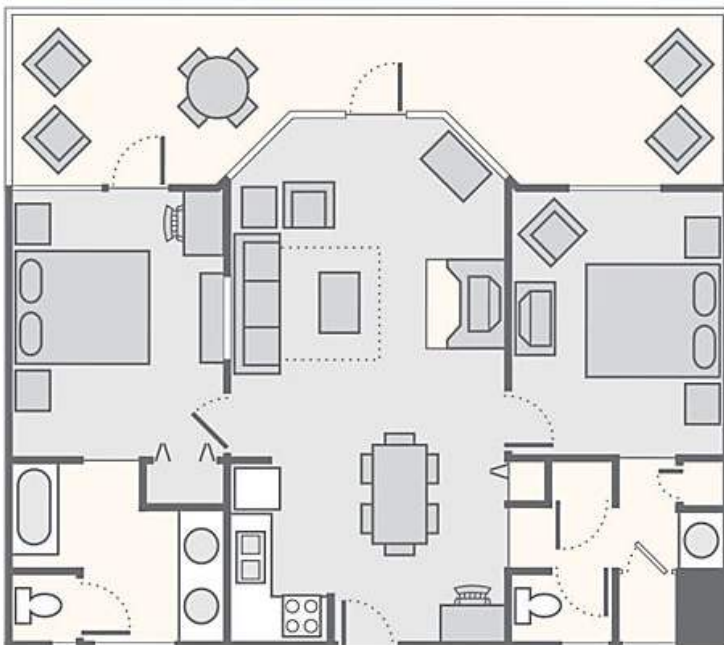

Note: the pictures below are for the Presidential version of the cabin; the layout of the regular 2 BR cabin is similar, but it not as finely appointed.



For more: <https://www.bluegreenvacations.com/resorts/missouri/wilderness-club-big-cedar>





## Directions to the Wilderness Club at Big Cedar

Address: 1285 ESTATE DRIVE, RIDGEDALE, MISSOURI 65739

Phone: 417.348.4085



- Take 65 through Branson, continuing south.
- You will go through Hollister (it just off the map above) on your way out of town. It is the last stop for groceries, fast food, etc.
- Continue south until you get to state (or county) highway 86. Take a right (west).
- You go on it about ½ mile and you will see a sign for Big Cedar on your right. Take it.
- The road is curvy.

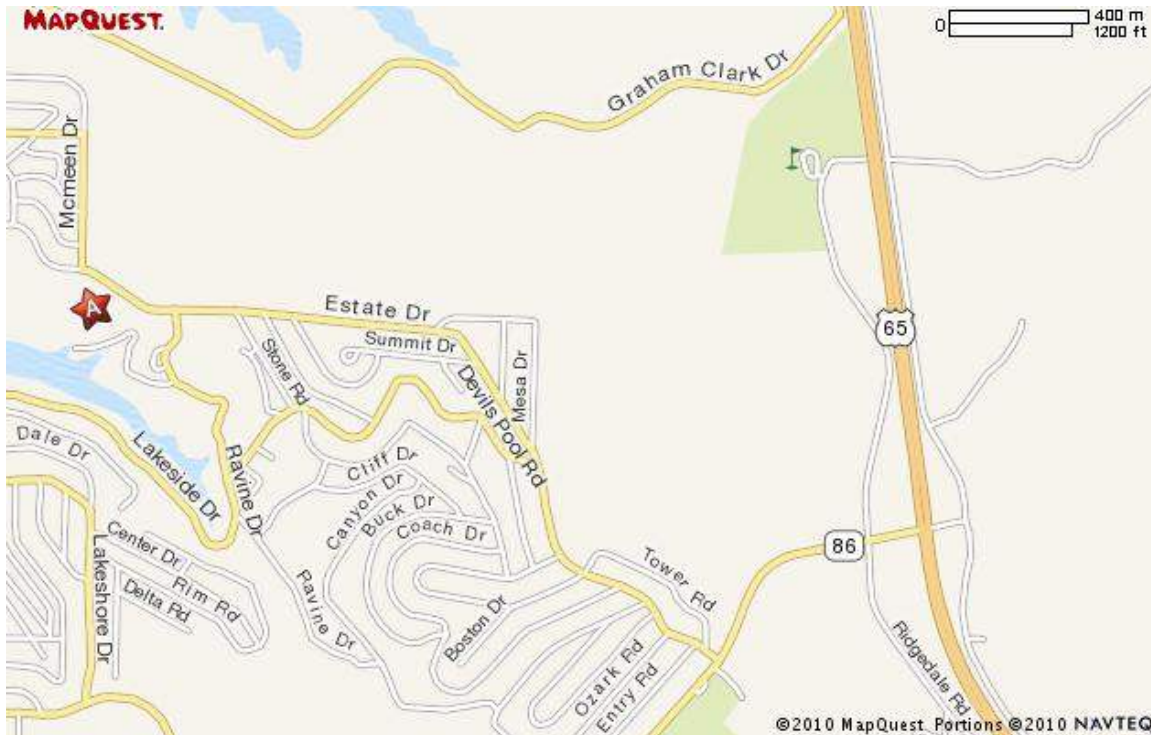

Directions continue:

- When you turn off highway 86, you will be on Devils Pool Rd. In about ½ mile or so, there will be a Y in the road. Devils Pool will go left, downhill. You want to take the right turn onto Estate Drive.
- Estate Drive will take you to the resort.
- Again, you want [Blue Green] Wilderness Club at Big Cedar.

A few notes:

- You will be charged \$10/day. It is mandatory but will give you access to all the Big Cedar facilities.
- Our resort is the Wilderness Club at Big Cedar. It is a newer resort. “Big Cedar itself is older and separate. But you can use their facilities. They have a 9 hole putt-putt course for kids, shuffleboard, a nice exercise facility for adults (there is one at the Wilderness Club but a much nicer one at the Big Cedar facility).
- They have an assortment of games and puzzles you can check out.
- There are shuttle buses that will take you around the facilities at no cost. Just give the desk a call and it will be there within a few minutes.
- They bring cookies every night.
- It includes free internet access
- For groceries, there nearest places are in Hollister, which you will go through as you are heading out of Branson, as you continue south of 65.